

vtech[®]
Baby

Parent's Guide

Newborn Necessities Gift Set™



91-003657-000 US

INTRODUCTION

Thank you for purchasing the **Newborn Necessities Gift Set™**! Perfect for new babies, this must-have gift set includes a teether, rattle, baby-safe mirror and an interactive piano that plays sing-along songs and melodies.



INCLUDED IN THIS PACKAGE

- One electronic piano
- One flower mirror
- One frog rattle
- One hippo teether
- One parent's guide

WARNING: All packing materials, such as tape, plastic sheets, packaging locks, removable tags, cable ties and packaging screws are not part of this toy, and should be discarded for your child's safety.

ATTENTION : Pour la sécurité de votre enfant, débarrassez vous de tous les produits d'emballage tels que rubans adhésifs, feuilles de plastique, attaches, étiquettes et vis d'emballage. Ils ne font pas partie du jouet.

NOTE: Please keep this parent's guide as it contains important information.

NOTE : Il est conseillé de conserver ce guide des parents car il comporte des informations importantes.

Unlock the packaging locks:

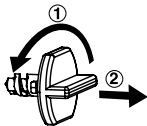

- ① Turn the packaging lock counterclockwise several times.
- ② Pull out and discard the packaging lock.

GETTING STARTED

BATTERY INSTALLATION

1. Make sure the unit is turned **Off**.
2. Locate the battery cover on the bottom of the electronic piano. Use a screwdriver to loosen the screw.
3. Install 3 new AAA (AM-3/LR6) batteries following the diagram inside the battery box. (The use of new alkaline batteries is recommended for maximum performance.)
4. Replace the battery cover and tighten the screw to secure the battery cover.

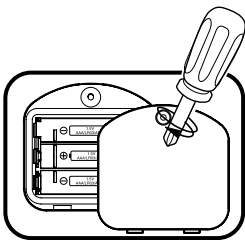

BATTERY NOTICE

- Use new alkaline batteries for maximum performance.
- Use only batteries of the same or equivalent type as recommended.
- Do not mix different types of batteries: alkaline, standard (carbon-zinc) or rechargeable, or new and used batteries.
- Do not use damaged batteries.
- Insert batteries with the correct polarity.
- Do not short-circuit the battery terminals.
- Remove exhausted batteries from the toy.
- Remove batteries during long periods of non-use.
- Do not dispose of batteries in fire.
- Do not charge non-rechargeable batteries.
- Remove rechargeable batteries from the toy before charging (if removable).
- Rechargeable batteries are only to be charged under adult supervision.

PRODUCT FEATURES

1. To turn the piano **On**, slide the **On/Off/Volume Control Switch** to the **Low Volume** (🔊) or the **High Volume** (🔊) position. To turn the piano **Off**, slide the **On/Off/Volume Control Switch** to the **Off** (●) position.

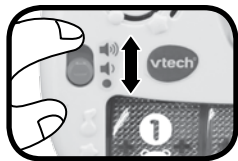

2. Automatic Shut Off

To preserve battery life, the piano will automatically power down after approximately 50 seconds without input. The unit can be turned on again by pressing any button.

NOTE: If the unit powers down while playing, we suggest changing the batteries.

ACTIVITIES

1. Light-Up Piano Keys

Press the **Light-Up Piano Keys** to learn about animals, numbers, colors, shapes and hear playful songs and music. The lights will flash with the sounds.



SONG LYRICS

Song 1

Tap on the piano,
Play a sweet song.
Hear the beautiful music,
You'll want to sing along.

Song 2

I'm a hippo, I'm friendly.
I've got a big tummy.
Twist me, turn me, tickle me.
I'm so much fun, you will see!

Song 3

Frog likes to hop, hop, hop!
He jumps in the water, splish splash!

Song 4

Smiley butterfly,
You flap your big strong wings.
Flap, flap, flap, flap,
Time to fly away!

MELODY LIST

1. MacNamaras Band
2. Animal Fair
3. Aba Daba Honeymoon
4. Teddy Bears' Picnic
5. Georgie Porgie
6. Froggy Went a Courtin'
7. Jack Be Nimble
8. One, Two Buckle My Shoe
9. Pop! Goes the Weasel
10. Ding Dong Bell
11. Aiken Drum

12. Did You Ever See a Lassie?
13. Yankee Doodle
14. Three Little Kittens
15. Mary, Mary Quite Contrary

CARE & MAINTENANCE

1. Keep the unit clean by wiping it with a slightly damp cloth.
2. Keep the unit out of direct sunlight and away from any direct heat sources.
3. Remove the batteries when the unit will not be in use for an extended period of time.
4. Do not drop the unit on a hard surface and do not expose the unit to excess moisture.

TROUBLESHOOTING

If for some reason the program/activity stops working or malfunctions, please follow these steps:

1. Please turn the unit **OFF**.
2. Interrupt the power supply by removing the batteries.
3. Let the unit sit for a few minutes, then replace the batteries.
4. Turn the unit **ON**. The unit should now be ready to play again.
5. If the product still does not work, replace with a new set of batteries.

If the problem persists, please call our Consumer Services Department at 1-800-521-2010 in the U.S. or 1-877-352-8697 in Canada, or by going to our website at vtechkids.com and filling out our Contact Us form located under the Customer Support link. A service representative will be happy to help you.

IMPORTANT NOTE:

Creating and developing **VTech®** products is accompanied by a responsibility that we at **VTech®** take very seriously. We make every effort to ensure the accuracy of the information, which forms the value of our products. However, errors sometimes can occur. It is important for you to know that we stand behind our products and encourage you to call our Consumer Services Department at 1-800-521-2010 in the U.S. or 1-877-352-8697 in Canada, or by going to our website at vtechkids.com and filling out our Contact Us form located under the Customer Support link with any problems and/or suggestions that you might have. A service representative will be happy to help you.

Note:

This equipment has been tested and found to comply with the limits for a Class B digital device, pursuant to Part 15 of the FCC Rules. These limits are designed to provide reasonable protection against harmful interference in a residential installation. This equipment generates, uses and can radiate radio frequency energy and, if not installed and used in accordance with the instructions, may cause harmful interference to radio communications. However, there is no guarantee that interference will not occur in a particular installation. If this equipment does cause harmful interference to radio or television reception, which can be determined by turning the equipment off and on, the user is encouraged to try to correct the interference by one or more of the following measures:

- Reorient or relocate the receiving antenna.
- Increase the separation between the equipment and receiver.
- Connect the equipment into an outlet on a circuit different from that to which the receiver is connected.
- Consult the dealer or an experienced radio/TV technician for help.

THIS DEVICE COMPLIES WITH PART 15 OF THE FCC RULES. OPERATION IS SUBJECT TO THE FOLLOWING TWO CONDITIONS: (1) THIS DEVICE MAY NOT CAUSE HARMFUL INTERFERENCE, AND (2) THIS DEVICE MUST ACCEPT ANY INTERFERENCE RECEIVED, INCLUDING INTERFERENCE THAT MAY CAUSE UNDESIRE OPERATION.

CAN ICES-3 (B)/NMB-3(B)

Caution: Changes or modifications not expressly approved by the party responsible for compliance could void the user's authority to operate the equipment.

Supplier's Declaration of Conformity

Trade Name:	VTech®
Model:	5220
Product name:	Newborn Necessities Gift Set™
Responsible Party:	VTech Electronics North America, LLC
Address:	1156 W. Shure Drive, Suite 200, Arlington Heights, IL 60004
Website:	vtechkids.com

**Visit our website for more
information about our products,
downloads, resources and more.**

vtechkids.com



TM & © 2019 VTech Holdings Limited.
All rights reserved.
Printed in China.
91-003657-000 